

PROPOSED PLANT LIST
TREES / PALMS

Code	Drought	QTY.	Botanical Name / Common Name	Specifications
BS (N)	V	4	Bursera simaruba / Gumbo Limbo	B&B Field Grown, 3" DBH, 5' Wide, 12' OA
ED	V	1	Elaeagnus decipiens/Japanese Blueberry --Layered Topiary	B&B Field Grown, 3" DBH, 6' Wide, 15' OA
EF	V	6	Eugenia foetida / Spanish Stopper	B&B Field Grown, 2-1/2" DBH, 6' Wide, 12' OA
PL	V	7	Paidium littorale / Cattleya Guava--Multitrunk	B&B Field Grown, 2-1/2" DBH, 6' Wide, 12' OA
SS	V	2	Senna surratensis / Glaucous Cassia	B&B Field Grown, 2-1/2" DBH, 6' Wide, 12' OA

ACCENTS / SHRUBS / GROUND COVERS

Code	Drought	QTY.	Botanical Name / Common Name	Specifications
DD	V	7	Dracaena deremensis / Dracaena Variegated Janet Craig	48" Tall x 24" Wide, 2' OC
LM	V	225	Liriope muscari / Liriope	12" Tall x 12" Wide, 1' OC
PM	V	64	Podocarpus macrocarpa / Podocarpus	30" Tall x 24" Wide, 2' OC
PV	V	10	Pyrostegia venusta / Flame Vine	48" Tall x 24" Wide, 2' OC
SAV	V	12	Schafferia abrotanica variegata / Trisetia	30" Tall x 24" Wide, 2' OC
TA	V	75	Trachelospermum asiaticum / Asiatic Jasmine	6" Tall x 18" Wide, 2' OC
VRI	V	6	Vriesea sp / Vriesea	24" Tall x 18" Wide, 2' OC

MISCELLANEOUS

Code	Drought	QTY.	Botanical Name / Common Name	Specifications
SOD	M		Stenotaphrum secundatum / St. Augustine 'Floratum'	Solid application - no gaps between seams

NOTES:
GENERAL PLANTING REQUIREMENTS

All sizes shown for plant material on the plans are to be considered Minimum. All plant material must meet or exceed these minimum requirements for both height and spread. Any other requirements for specific shape or effect as noted on the plan(s) will also be required for final acceptance.

All plant material furnished by the landscape contractor shall be Florida #1 or better as established by "Grades and Standards for Florida Nursery Plants" and "Grades and Standards for Florida Nursery Trees". All material shall be installed as per CSI specifications.

All plant material as included herein shall be warranted by the landscape contractor for a minimum period as follows: All trees and palms for 12 months, all shrubs, vines, groundcovers and miscellaneous planting materials for 90 days, and all lawn areas for 60 days after final acceptance by the owner or owner's representative.

All plant material shall be planted in planting soil that is delivered to the site in a clean loose and friable condition. All soil shall have a well drained characteristic. Soil must be free of all rocks, sticks, and objectionable material including weeds and weed seeds as per CSI specifications.

Twelve inches (12") of planting soil 50/50 sand/topsoil mix is required around and beneath the root ball of all trees and palms, and 1 cubic yard per 50 bedding or groundcover plants.

All landscape areas shall be covered with Eucalyptus or sterilized seed free Melaleuca mulch to a minimum depth of three inches (3") of cover when settled. Cypress bark mulch shall not be used.

All plant material shall be thoroughly watered in at the time of planting; no dry planting permitted. All plant materials shall be planted such that the top of the plant ball is flush with the surrounding grade.

All landscape and lawn areas shall be irrigated by a fully automatic sprinkler system adjusted to provide 100% coverage of all landscape areas. All heads shall be adjusted to 50% overlap as per manufacturers specifications and performance standards utilizing a rust free water source. The system shall be installed with a rain sensor.

It is the sole responsibility of the landscape contractor to insure that all new plantings receive adequate water during the installation and during all plant warranty periods. Deep watering of all new trees and palms and any supplemental watering that may be required to augment natural rainfall and site irrigation is mandatory to insure proper plant development and shall be provided as a part of this contract.

Special Note

No items to be stored higher than the screening wall or fence.

All plant material shall be installed with fertilizer, which shall be State approved as a complete fertilizer containing the required minimum of trace elements in addition to N-P-K, of which 50% of the nitrogen shall be derived from an organic source as per CSI specifications.

Contractors are responsible for coordinating with the owners and appropriate public agencies to assist in locating and verifying all underground utilities prior to excavation.

All ideas, designs and plans indicated or represented by this drawing are owned by and are the exclusive property of Wayne K. Tanning, R.L.A.

The plan takes precedence over the plant list.

SPECIAL INSTRUCTIONS

General site and berm grading to +/- 1 inch (1") shall be provided by the general contractor. All finished site grading and final decorative berm shaping shall be provided by the landscape contractor.

All sod areas as indicated on the planting plan shall receive Stenotaphrum secundatum, St. Augustine 'Floratum' solid sod. It shall be the responsibility of the landscape contractor to include in the bid, the repair of any sod which may be damaged from the landscape installation operations.

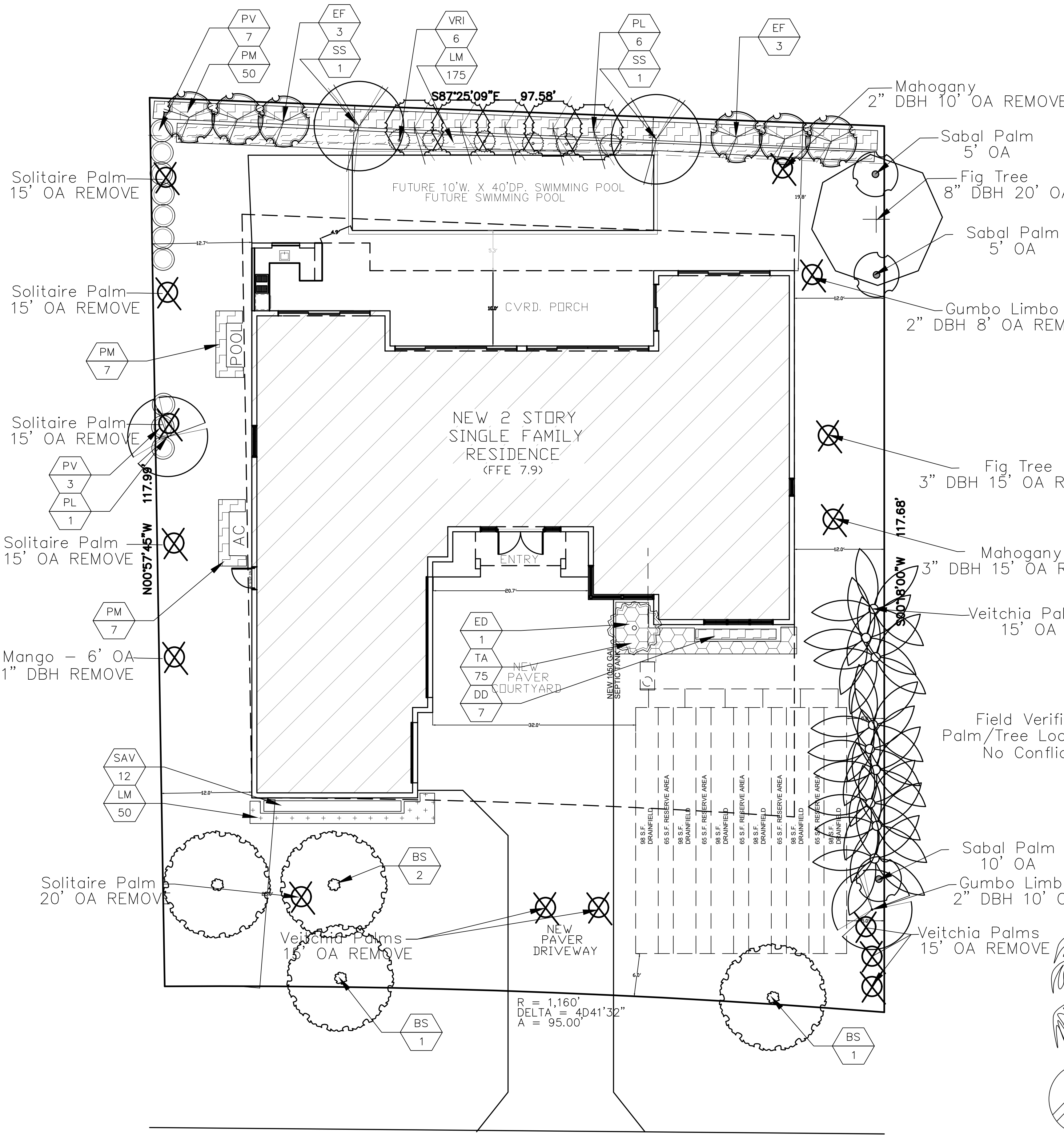

Mahogany
2" DBH 10' OA REMOVE

Sabal Palm
5' OA

Fig Tree
8" DBH 20' OA

Sabal Palm
5' OA

Gumbo Limbo
2" DBH 8' OA REMOVE

Fig Tree
3" DBH 15' OA REMOVE

Mahogany
3" DBH 15' OA REMOVE

Veitchia Palms
15' OA

Sabal Palm
10' OA

Gumbo Limbo
2" DBH 10' OA

Veitchia Palms
15' OA REMOVE

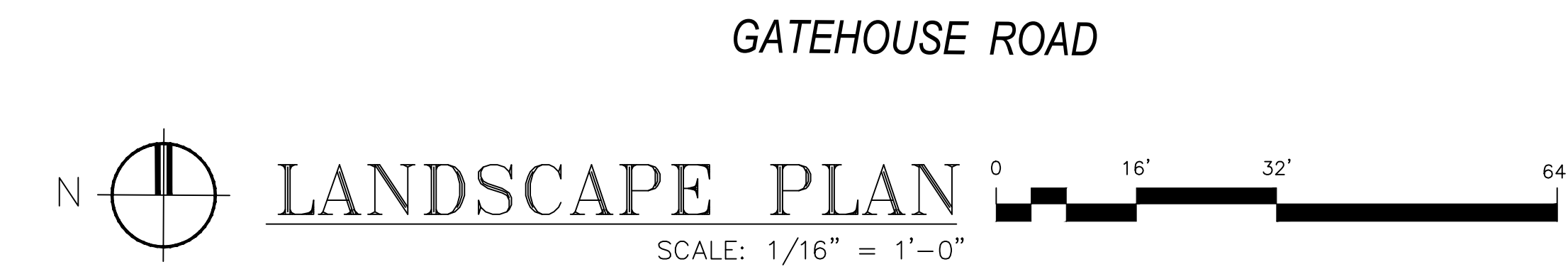
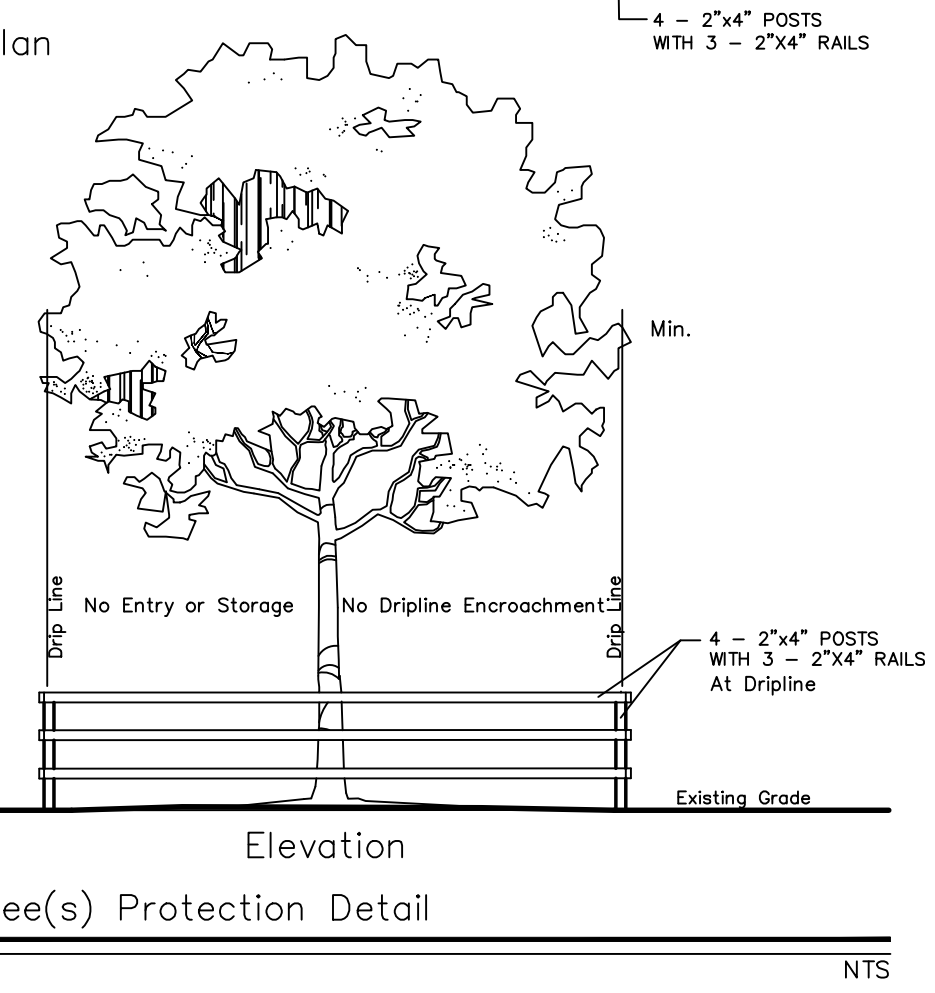
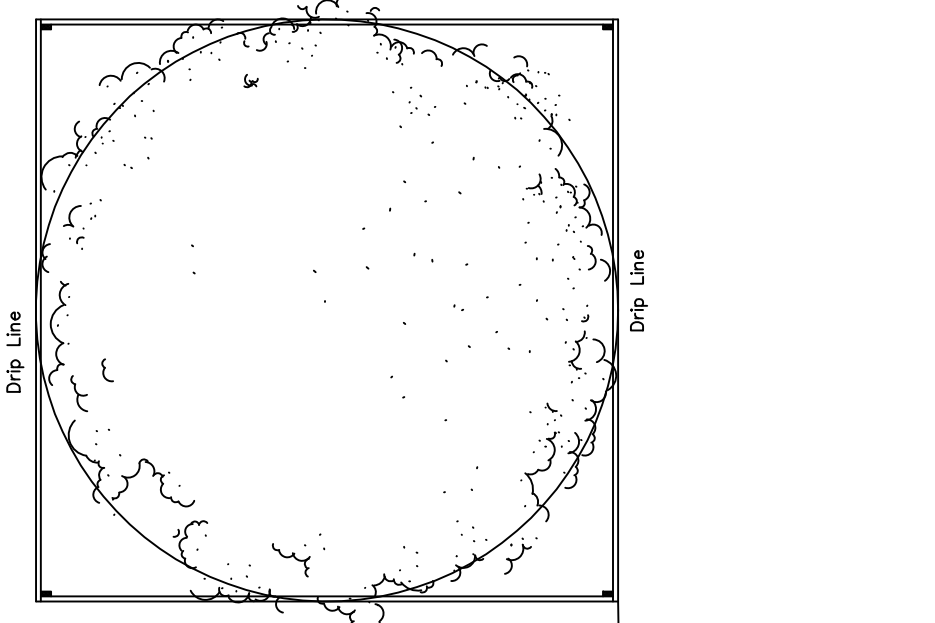
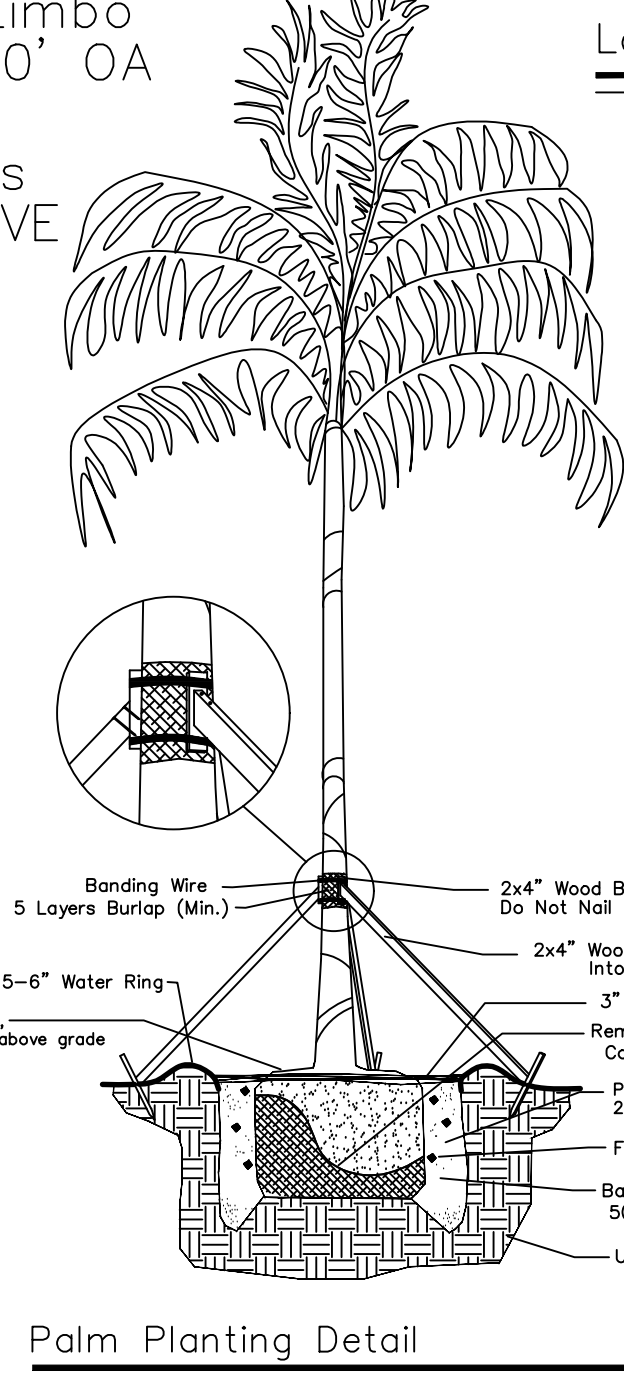
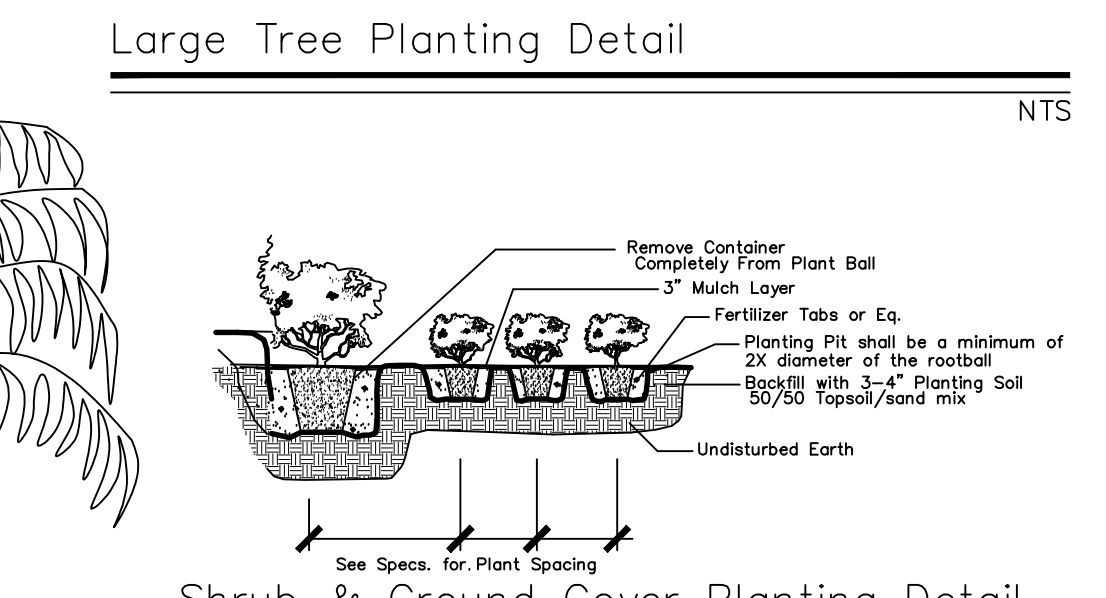
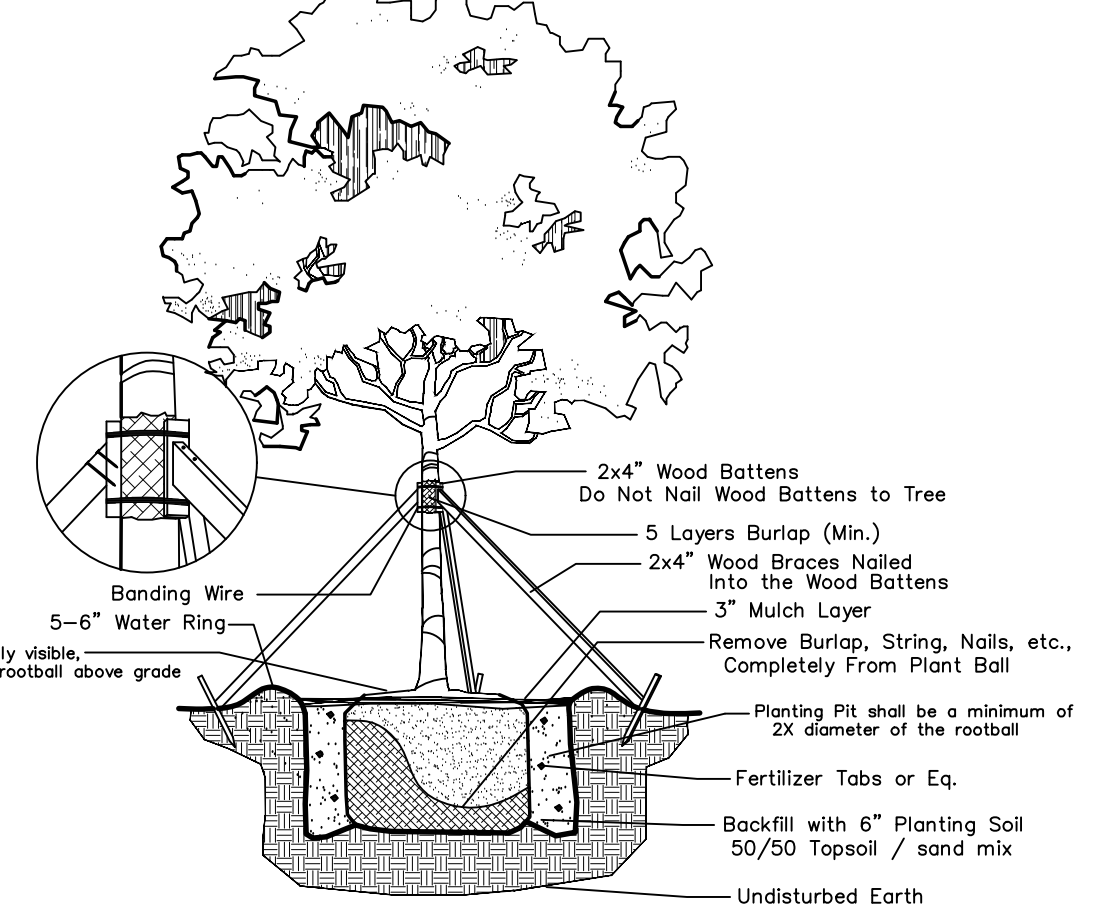

TONNING & ASSOCIATES, INC.
Landscape Architecture & Land Planning

Landscape Architect - Florida License #6666709
4855 NW 92 Terrace
Coral Springs, Florida
Tel: 561-414-8269 Email: w.tanning@tonningandassociates.com

DRWG. TITLE : **LANDSCAPE PLAN**

PROJECT : **RESIDENCE**
7 GATEHOUSE
SEA RANCH LAKES, FLORIDA 33325

CLIENT : **GALLON**

PROJECT NO. 21-124

DRAWN BY WKT

DESIGNED BY WKT

CHECKED BY WKT

DATE : 09-14-21

DWG. NO. LP-1

SHT. NO. 1 of 1

REVISIONS : _____

03-08-22