

PLANT MATERIAL SCHEDULE

SYM	DESCRIPTION	BOTANICAL NAME	SPECIFICATION
AF 4	ANNUAL FLOWERS	SEASONAL COLOR	4" pots, 12" ht., 12" o.c.
ASD 3	ASPARAGUS DENSIFLORUS M.	FOXTAIN FERN	3 gal. 15" ht., 12" spr. 18" o.c.
CE 10	CONOCARPUS ERECTUS	GREEN BUTTWOOD TREE	10" o.d. ht., 5' spr.
CE 7	CONOCARPUS ERECTUS 5ER	SILVER BUTTWOOD HEDGE	7 gal. 24" ht., full to base
CL 7	CLUSIA HEDGE	CLUSIA ROSEA	7 gal. 24" ht., full to base
CMG 7	COCCOS NUCIFERA	GREEN MALAYAN COCONUT	7' air wood
DD 8	FICUS MICROCARPA	JAPANESE BLUEBERRY	8" o.d. ht.
FBI 3	FICUS MICROCARPA	GREEN ISLAND FIGUS	3 gal. 15" ht., 12" spr. 18" o.c.
HL 3	HEMBROCAS LAMPANA	SHADE LILY	3 gal. 15" ht., 12" spr. 18" o.c.
LL 10	LIGUSTRUM JAPONICUM	LIGUSTRUM TREE	10" ht., 10" spr. Multi stem
NO 3	NERIUM OLEANDER	PETEE PINK OLEANDER	3 gal. 15" ht., 12" spr. 18" o.c.
PEC 3	PHELODENDRON 5PP	BLACK CARDINAL PHELODENDRON	3 gal. 15" ht., 12" spr. 18" o.c.
SA 7	SCHIFFELERA ARBORICOLA	GREEN SCHEFFELERA	7 gal. 24" ht., full to base
SN 15	STRELTZIA NICOLAI	BIRD OF PARADISE	15 gal.
SOD	ST. AUGUSTINE SOD	STENOTAPHRUM SECUNDATUM	wood free solid sod
TE 3	TIPSACUM FLORIDANA	KAKAHUACHE GRASS	3 gal. 15" ht., 12" spr. 24" o.c.
ZE 7	ZAMIA FLURIFRACA	CARDONIA PALM	7 gal. full

CEB 3 CAROLINA EMERALD BLANSET

LL 8 LIGUSTRUM JAPONICUM

NO 3 NERIUM OLEANDER

PEC 3 PHELODENDRON 5PP

SA 7 SCHIFFELERA ARBORICOLA

3 GAL. 12" X 6" HT. 12" O.C.

8" HT. X 8" SPR. MULTI TRK.

3 GAL. 15" X 12" SPR. 18" O.C.

3 GAL. 15" X 12" SPR. 18" O.C.

3 GAL. 15" X 12" SPR. 18" O.C.

PLANT DETAILS

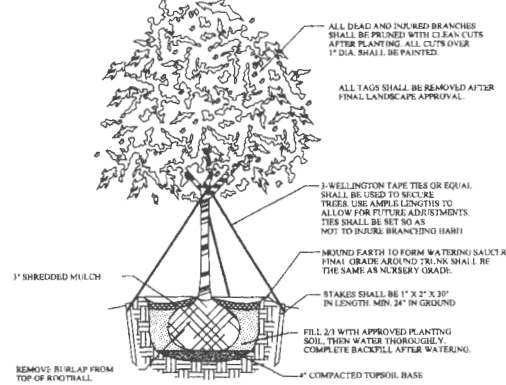

PLANTING AND STAKING DETAIL-UP TO 6" CALIPER

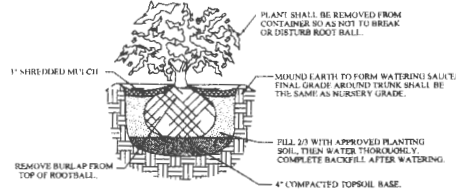
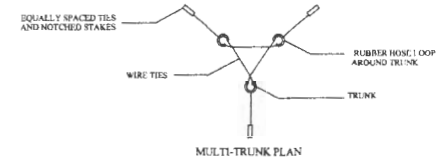

PLANTING DETAIL-CONTAINER GROWN SHRUBS

SHRUB PLANTING DETAIL

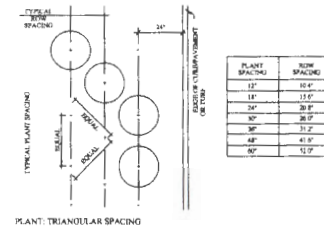

PLANT: TRIANGULAR SPACING

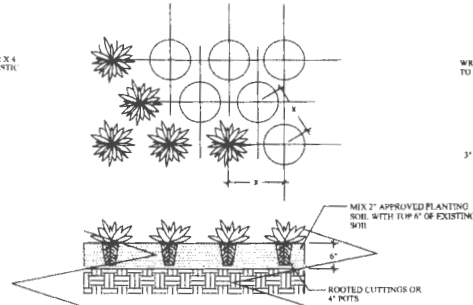

PLANTING DETAIL-GROUNDCOVER BEDS

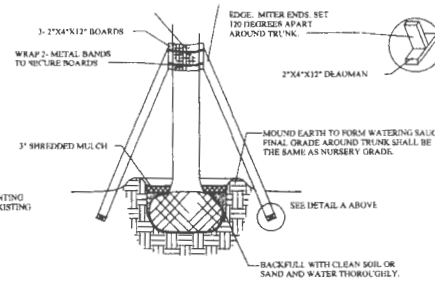

PLANTING AND STAKING DETAIL-PALMS

1. The drawings, Nomenclature shall conform to the Florida Department of Plant Conservation published by the Florida Department of Plant Conservation, or as determined by the Florida Division of Plant Conservation, slightly knit plant, so trained or favored side and outstandingly superior in form, number of

1. well branched and free of disease and insect damage. Trees for planting rows shall be uniform in size by the Landscape Architect. Where any furnished shall be normal for the variety. Plants of the Landscape Architect.

1. shall be added at a rate of seventy-five (75%) of soil mix shall be used in all plant pits except planting soil shall be a fertile, friable natural to fifty (50) percent decomposed organic matter and other foreign materials or noxious grasses shall not contain toxic substances which may be

except palms. Granular fertilizer shall be uniform all be delivered to the site in the original unopened bags, and shall meet the following requirements: phosphorus, twelve (12) percent potassium, plus size shall meet the following requirements: twenty five (25) percent potassium.

FORM TABLET (21 Grams)

1
2
4
2 1/2" caliper
2 1/2" caliper

1. all plants at installation at a rate of 1/2 lb. per inch of CYPRRESS mulch (sterilized and free of seeds) or to prevent wind displacement.

1. allowed without written consent of the Landscape Architect for container grown material unless previously in bid.

1. well rooted plants, and established in the tops which are good quality and in a healthy

1. that container sufficiently long enough for the pot mass will retain its shape and hold together when

1. Variety or Specimen, shall be Florida Grade Number 1 or its Industry.

1. irrigation system providing 100% coverage. -

1. shall be as per the Plant Details and Plant Specifications and contact appropriate agencies to for commencing work. Any utilities or unanticipated landscape Architect.

1. clearing all necessary permits, licenses, inspections, and

1. shall clearance to utilities of 5 feet for trees and palms.

1. root barrier such as Bio-Barrier

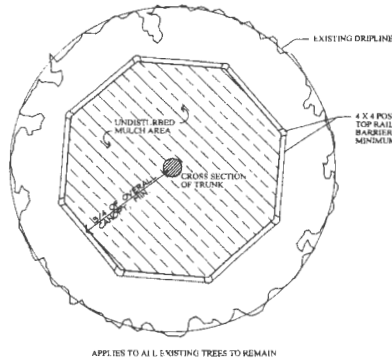

TREE PROTECTION DETAIL

gwk
GEORGE KEEN
LANDSCAPE ARCHITECT
 15 SE 9TH AVENUE
 FORT LAUDERDALE
 FLORIDA 33301
 TEL. 954-295-1377
 FAX. 954-763-4704
 info@gwklandscape.com

GRAY RESIDENCE
 49 CAYUGA ROAD
 SEA RANCH LAKES, FLORIDA
 LANDSCAPE NOTES / DETAILS

DATE: 06-14-21
 DRAWN BY: GWK
 SCALE: N.T.S.

REVISIONS:
 1. LANDSCAPE 05-13-21

SEAL:

SHEET:
LS-2

UTILITIES AND ROOT BARRIERS
 Landscaping will provide a minimum horizontal clearance to utilities of 5 feet for small trees and palms and 10 feet for large trees and palms.
 Utilities will be protected using an approved root barrier such as Bio-Barrier

gwk

GEORGE KEEN
 LANDSCAPE ARCHITECT
 15 SE 9TH AVENUE
 PORT LAUDERDALE
 FLORIDA 33301
 TEL. 954-296-5377
 FAX. 954-763-4704
 keeng@bdlacomb.net

GRAY RESIDENCE
 49 CAYUGA ROAD
 SEA RANCH LAKES, FLORIDA
 LANDSCAPE PLAN

DATE: 04-14-21
 DRAWN BY: GWK

SCALE: 1/8"=1'-0"

REVISIONS:
 1 LANDSCAPE 05-13-21



SEAL:

SHEET:
 LS-1

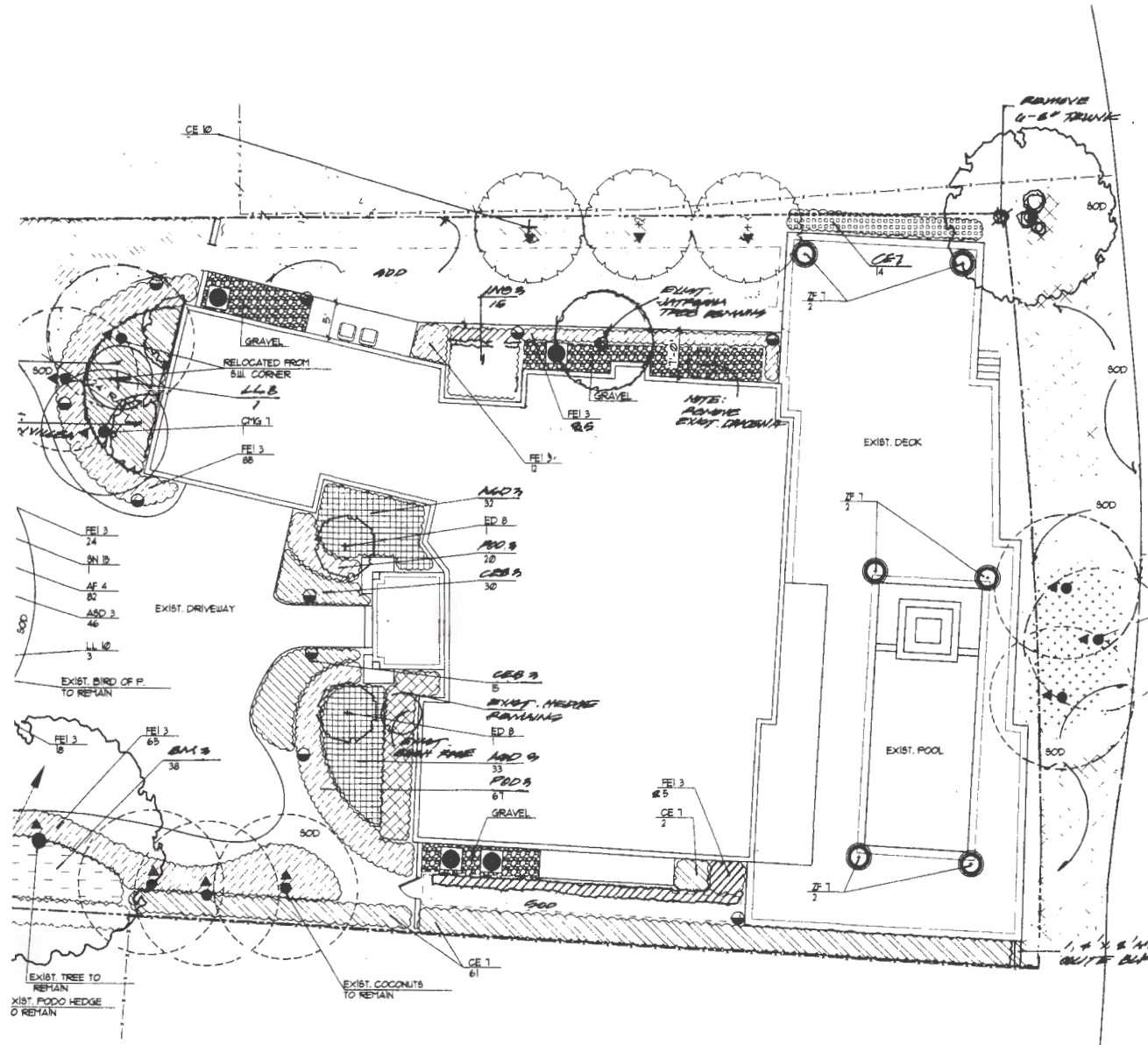

LANDSCAPE LIGHTING LEGEND

SYMBOL	FIXTURE DESCRIPTION	MOUNTING
●	KICHLER LIGHTING MODEL B600 AIT 12 V. PATHWAY LIGHT ARCH BRONZE FIN.	8" IN GROUND STAKE
▲	KICHLER LIGHTING MODEL B751AZT 12 V. 30 DEG. MEDIUM ACCENT LT. ARCH BRONZE FIN.	8" IN GROUND STAKE

ELECTRICAL CONTRACTOR TO VERIFY LOCATION OF ALL UNDERGROUND UTILITIES PRIOR TO INSTALLATION OF LANDSCAPE LIGHTING.

ELECTRICAL CONTRACTOR TO INCLUDE ALL HARDWARE BRING, J-BOXES AND TRANSFORMERS IN SCOPE OF INSTALLATION.

NO LIGHTING SUBSTITUTIONS SHALL BE ACCEPTED WITHOUT THE PRIOR WRITTEN PERMISSION OF THE LANDSCAPE ARCHITECT